

## PICNIC TABLE - SERIES C IN GROUND (PCG)

### SPECIFICATIONS

#### WOOD:

- 88.9 x 139.7 x 901.7mm  
(3 1/2" x 5 1/2" x 35 1/2") #1 GRADE  
SELECT CEDAR

#### STEEL TYPE:

- 101.6 x 101.6mm (4"x4") SQUARE  
TUBE CENTRE SUPPORT  
- 76.2 x 76.2mm (3"x3") SQUARE  
TUBE SEAT SUPPORTS  
- 76.2 x 76.2mm (3"x3") ANGLE  
IRON WOOD SUPPORTS

#### FASTENERS:

- 9.5mm (3/8") PLATED CARRIAGE  
BOLTS. COLOR MATCHED TO  
STEEL FRAME.

#### STEEL FINISH:

- 3 STEP POWDER COAT  
PROCESS:

1. SURFACE PREPARATION-  
SANDBLAST METAL
2. PRIME COAT- APPLICATION OF  
ZINC RICH PRIMER
3. TOP COAT- FINAL COATING IS  
BAKED ON FOR THE BEST IN LONG  
LASTING DURABILITY

#### WOOD FINISH:

- AVAILABLE IN LIFETIME  
PRESERVATIVE OR SIKKENS  
STAIN.

STEEL FRAME AVAILABLE IN A  
WIDE VARIETY OF COLORS.  
REFER TO COLOR CHART FOR  
MORE INFORMATION.

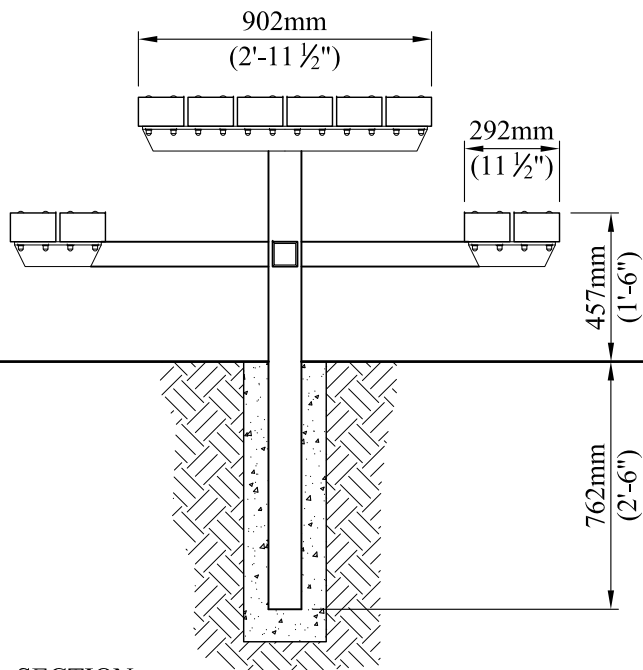

SECTION

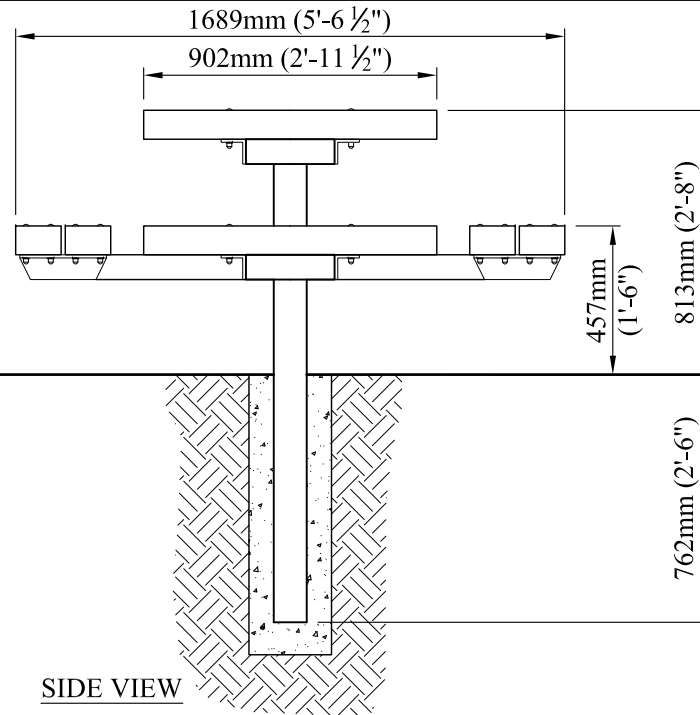

SIDE VIEW

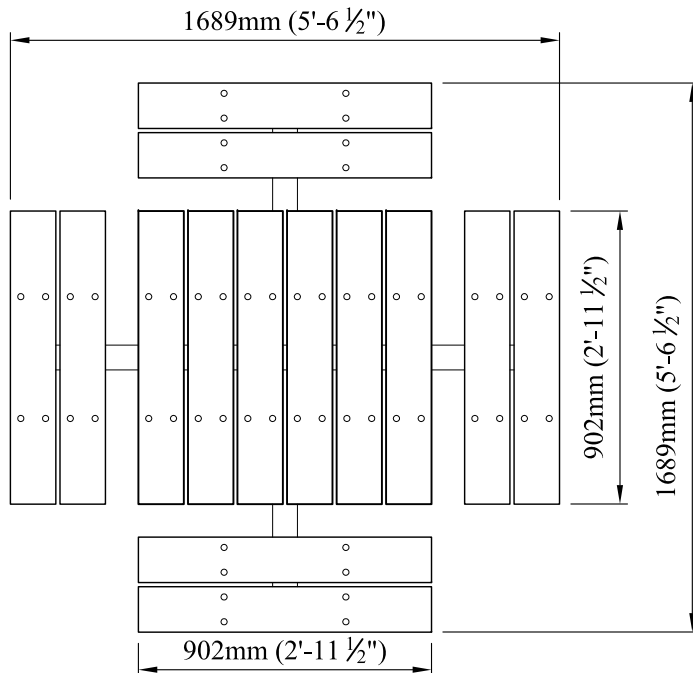

PLAN VIEW

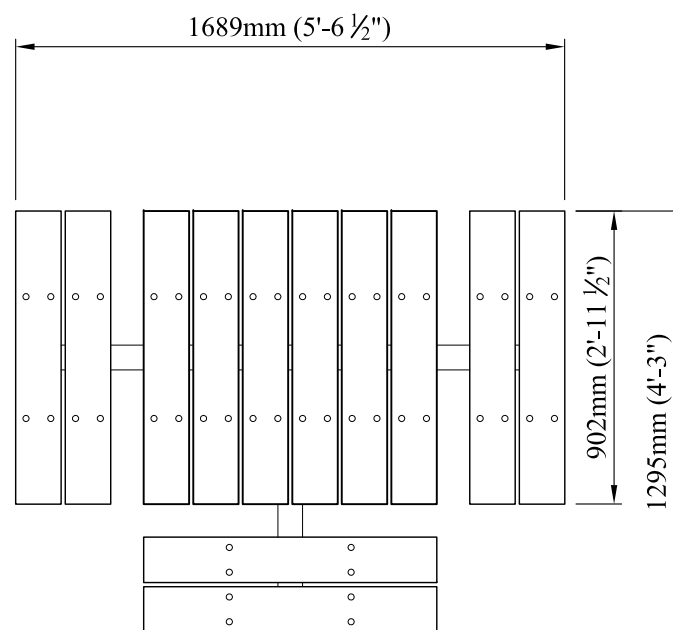

PLAN VIEW  
WHEELCHAIR ACCESSIBLE



4111-17th Street SE Calgary, AB T2G 3W5  
Ph# 569-8180 Fax# 272-4544  
e-mail: reception.cpl@telus.net  
[www.custompark.com](http://www.custompark.com)

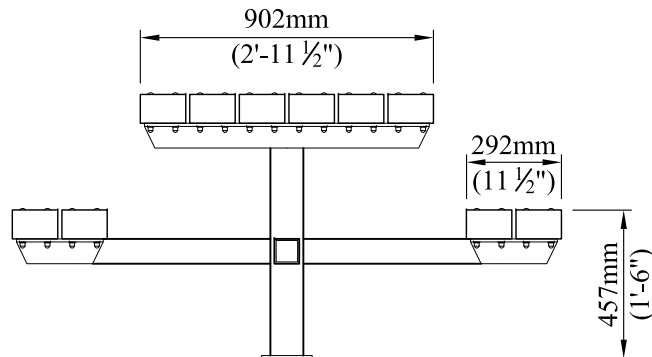

SECTION

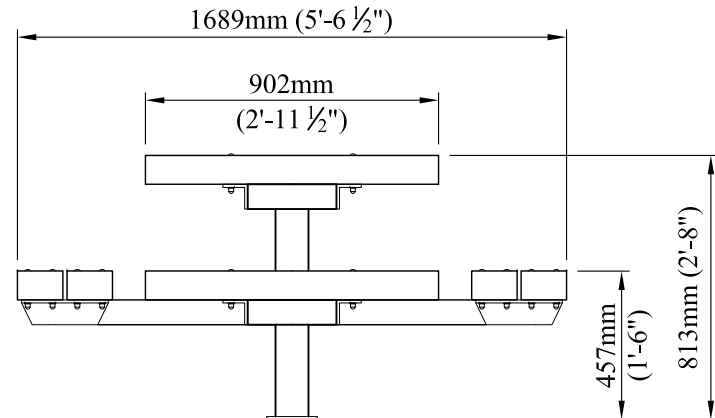

SIDE VIEW

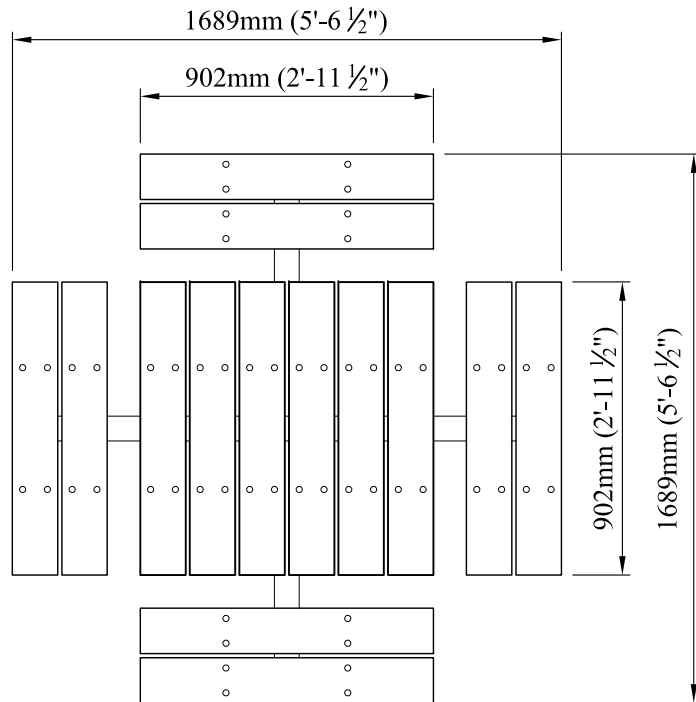

PLAN VIEW

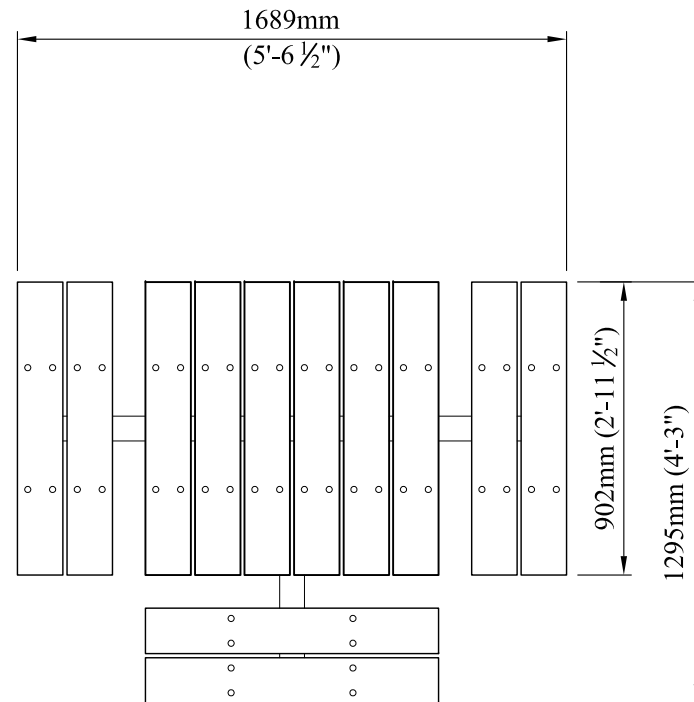

PLAN VIEW  
WHEELCHAIR ACCESSIBLE

**PICNIC TABLE - SERIES C  
SURFACE MOUNT (PCS)**

SPECIFICATIONS

WOOD:

- 88.9 x 139.7 x 901.7mm  
(3 1/2" x 5 1/2" x 35 1/2") #1 GRADE  
SELECT CEDAR

STEEL TYPE:

- 101.6 x 101.6mm (4"x4") SQUARE  
TUBE CENTRE SUPPORT  
- 76.2 x 76.2mm (3"x3") SQUARE  
TUBE SEAT SUPPORTS  
- 76.2 x 76.2mm (3"x3") ANGLE  
IRON WOOD SUPPORTS

FASTENERS:

- 9.5mm (3/8") PLATED CARRIAGE  
BOLTS. COLOR MATCHED TO  
STEEL FRAME.

STEEL FINISH:

- 3 STEP POWDER COAT  
PROCESS:

1. SURFACE PREPARATION-  
SANDBLAST METAL
2. PRIME COAT- APPLICATION OF  
ZINC RICH PRIMER
3. TOP COAT- FINAL COATING IS  
BAKED ON FOR THE BEST IN LONG  
LASTING DURABILITY

WOOD FINISH:

- AVAILABLE IN LIFETIME  
PRESERVATIVE OR SIKKENS  
STAIN.

STEEL FRAME AVAILABLE IN A  
WIDE VARIETY OF COLORS.  
REFER TO COLOR CHART FOR  
MORE INFORMATION.



4111-17th Street SE Calgary, AB T2G 3W5  
Ph# 569-8180 Fax# 272-4544  
e-mail: reception.cpl@telus.net  
[www.custompark.com](http://www.custompark.com)